

CUSTOMER COPY

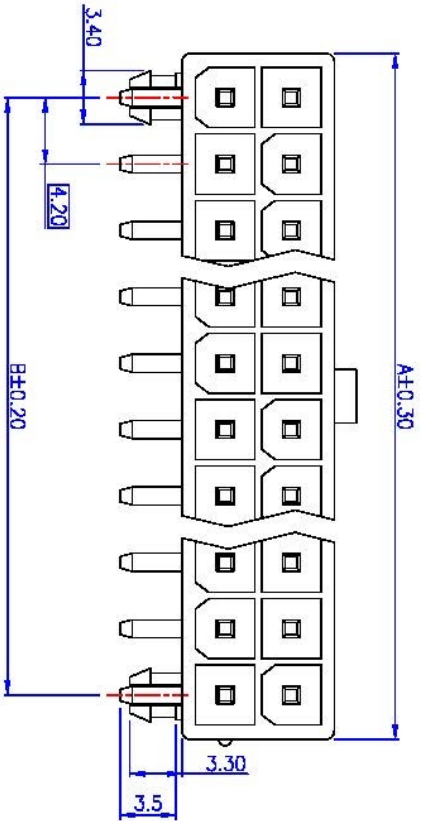

Dimensions		
Pos.	A	B
02	5.60	
04	9.80	4.20
06	14.00	8.40
08	18.20	12.60
10	22.40	16.80
12	26.60	21.00
14	30.80	25.20
16	35.00	29.40
18	39.20	33.60
20	43.40	37.80
22	47.60	42.00
24	51.80	46.20

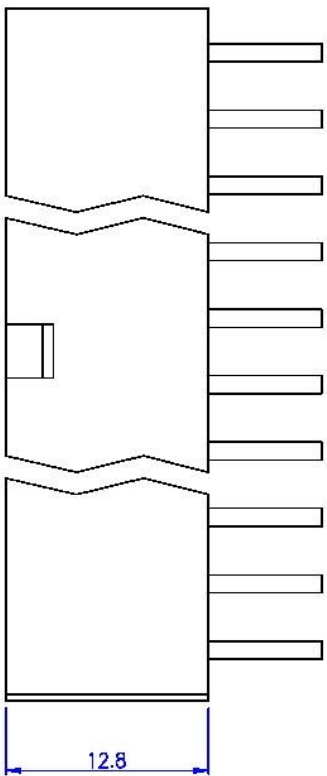
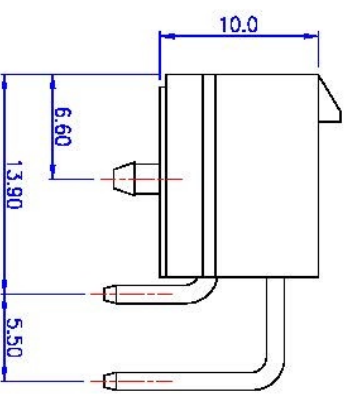

ORDER INFORMATION  
 1246 5 1 0XX 1  
 1:Plating Tin  
 No. of Contact  
 90° Style  
 Type

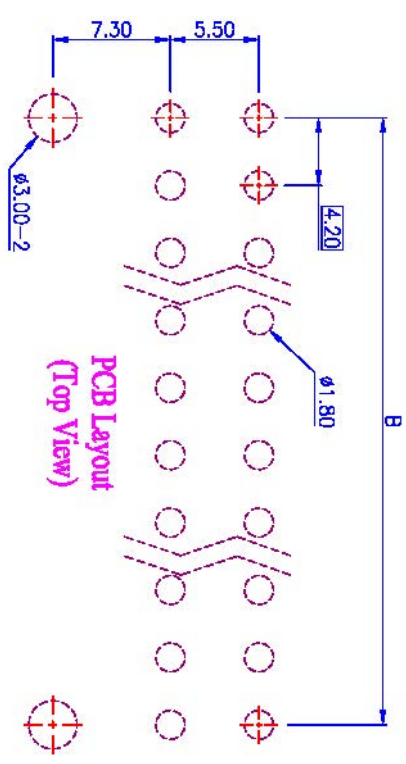

**Material and Finish**

1. Housing: Nylon 66 (UL94V-2)
2. Terminal: Sq. 1.4mm Brass, Tin Plating.

**Electrical Characteristics**

1. Current Rating: 7.0 Amp. Max.
2. Dielectric Withstand Voltage: 1000V AC RMS for 60Seconds.
3. Insulation Resistance: 1000M Ohms Min. at 1000V DC.

**Mechanical Characteristics**

1. Operating Temperature: -25°C ~ +85°C



鈺滿榮企業股份有限公司 ACME LUX CO., LTD.

TEL: 886-2-85124595

FAX: 886-2-85124322

0.0±0.30 SCALE: 1:1

0.00±0.20 UNIT: mm

0.000±0.10

TITLE: Pitch 4.2mm Right Angle Type MINI FIT Water Connector

MATL: ROHS

DWG. NO. C1246510XX1

PART NO:

APP BY: Hungl

CHK BY: Cheryl

DR BY: Amos

REV.	DESCRIPTION	APP.	DATE
A	NEW DESIGN	Amos	2014-06-26